

# Shinagawa Historical Museum Multi-lingual Commentary

1st floor

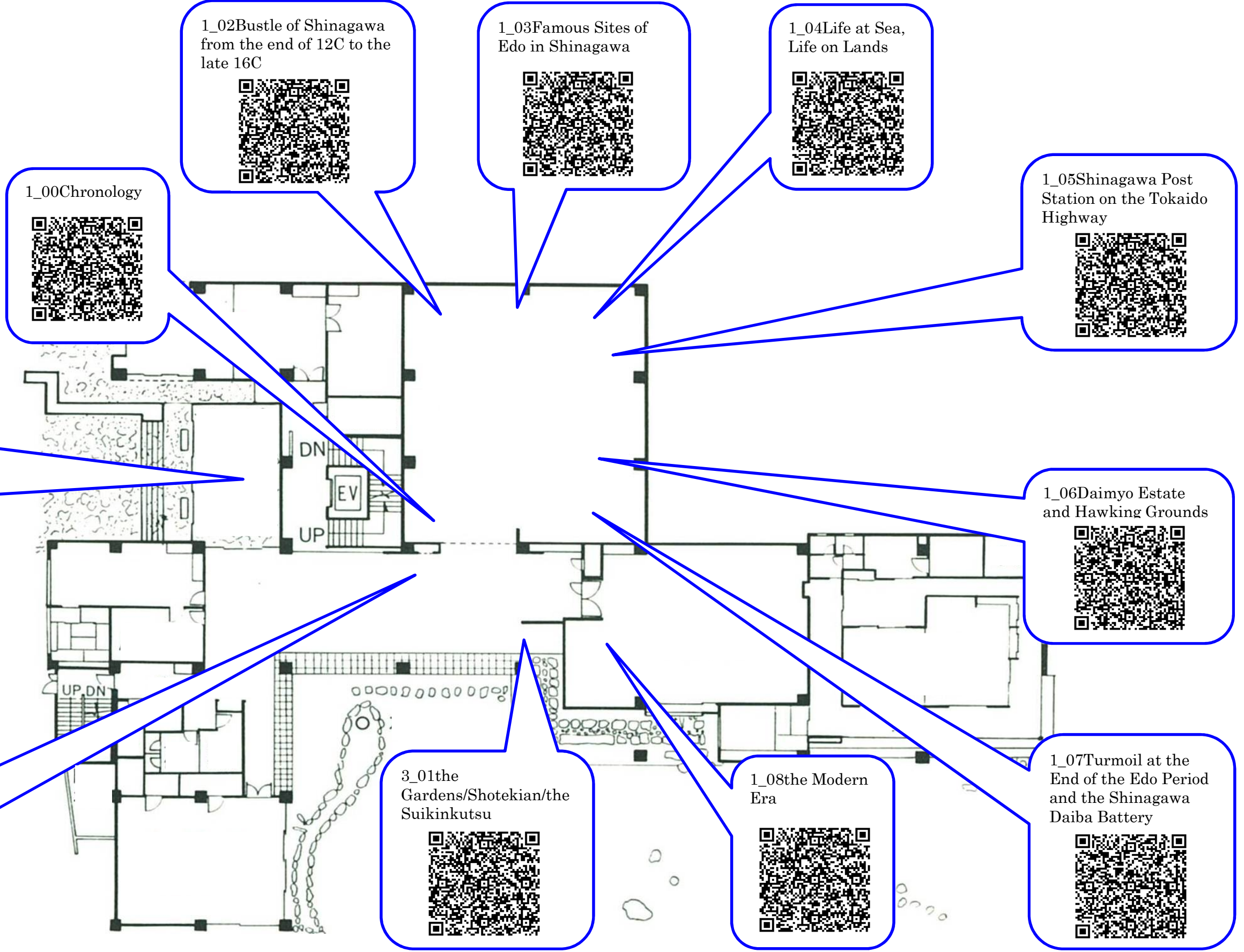

3\_02 Stone Works of Shinagawa Post Station and the Shinagawa Battery

1\_00 Chronology

1\_02 Bustle of Shinagawa from the end of 12C to the late 16C

1\_03 Famous Sites of Edo in Shinagawa

1\_04 Life at Sea, Life on Lands

1\_05 Shinagawa Post Station on the Tokaido Highway

1\_06 Daimyo Estate and Hawking Grounds

1\_07 Turmoil at the End of the Edo Period and the Shinagawa Daiba Battery

1\_08 the Modern Era

3\_01 the Gardens/Shotekian/the Suikinkutsu

0\_01 the Lobby

# Shinagawa Historical Museum Multi-lingual Commentary

2nd floor

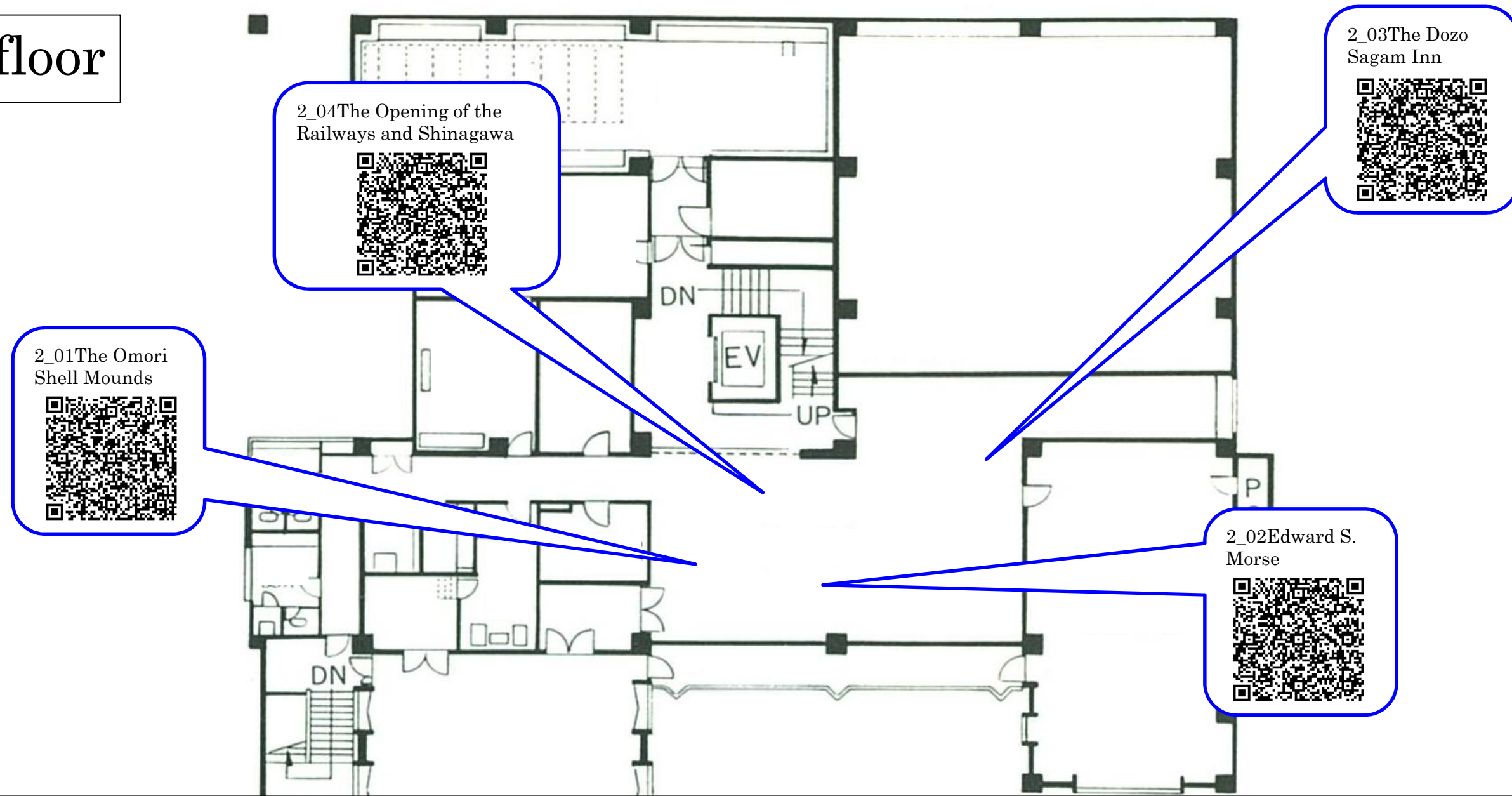

more commentary



English



Simplified Chinese



Traditional Chinese



Korean